

# MS L'Europe

4 anchors - Rhine and Danube Rivers - 90 cabins



# MS L'Europe

The MS L'Europe sails on the Rhine and the Danube Rivers.

## Interior design



## Cabins

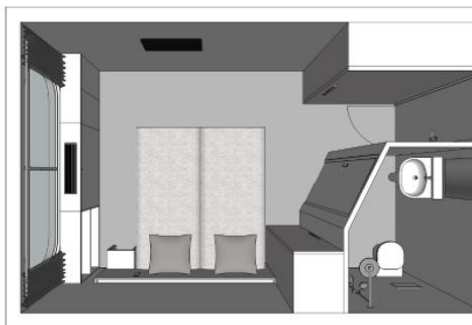

- Middle Deck 1 double bed 13 m<sup>2</sup>
- Upper Deck 2 beds - disabled person 16 m<sup>2</sup>
- Middle deck 2 adjustable twin beds 13 m<sup>2</sup>
- Main Deck 1 double bed 13 m<sup>2</sup>
- Main deck 2 adjustable twin beds 13 m<sup>2</sup>
- Upper Deck 1 double bed 13 m<sup>2</sup>
- Upper deck 2 adjustable twin beds 13 m<sup>2</sup>

## Cabins equipments

- TV
- Telephone (for internal calls only)
- Bathroom with shower and toilet
- Towels
- Safe
- Independent air-conditioning
- Electricity 220V
- Wi-Fi

Please note that there is no laundry service on board the ship.

## Decks and technical details

### MAIN DECK 21 cabins

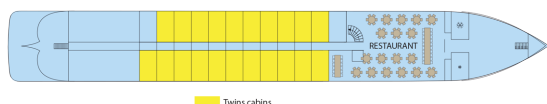

### MIDDLE DECK 27 cabins

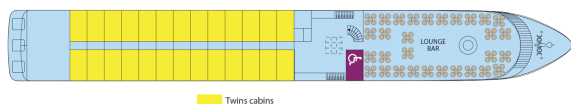

### UPPER DECK 42 cabins

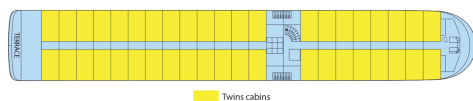

**Number of decks :** 3  
**Width :** 11.40  
**Guest capacity :** 180  
**Year Built :** 2006  
**Year Renovated :** 2016  
**Number of cabins :** 90  
**Length :** 110  
**Elevators**  
**PRM cabins**  
**Cabins outside**

## SUN DECK

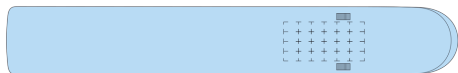

**MAIN DECK : RESTAURANT**

**MIDDLE DECK : RECEPTION DESK - LOUNGE BAR WITH DANCEFLOOR**

**UPPER DECK : PIANORAMABAR - TERRACE**

**SUN DECK : FITNESS - SUN DECK**